

A decorative border with a scalloped top and bottom edge, featuring stylized flowers and leaves in each corner and along the sides.

**The Friends of  
St James the Great, Chorley**  
Registered Charity No: 288678  
[www.friends.stjames.btinternet.co.uk](http://www.friends.stjames.btinternet.co.uk)

**FESTIVAL  
OF  
FLOWERS  
AND  
MUSIC**

**THEME:  
ENCOUNTERS WITH JESUS**

**26TH–28TH AUGUST 2006**

***PROGRAMME 50P***

## The Friends of St James the Great, Thorley

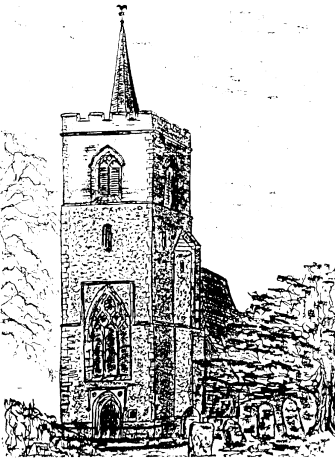

The Friends of St James was founded in 1983 to assist the Rector and Parochial Church Council in maintaining and beautifying the Church and Churchyard.

The first major project undertaken with funding from the Friends was the construction, in 1986, of a new north wall for the Churchyard. The August Bank Holiday weekend of 1987 saw the Friends launch an appeal to fund the renovation of our 12th century font, repairs to Church masonry, and the restoration of the stained glass windows and tower. The Church was decorated with flowers for this occasion which, by popular demand,

became the first in an annual series of Festivals of Flowers and Music, of which this year's event is the twentieth.

Within a year of the launch of the appeal the first of its objectives had been accomplished, with the return to the Church of our font, fully restored. Since then the Friends has funded numerous projects ranging from a new kissing gate, through lightning protection and a new weather vane and window restoration, to a substantial grant to the Parochial Church Council towards the first phase of restoration of the tower in 2001. The most recent project funded by the Friends was the renovation of the picturesque Lych Gate. The proceeds from this year's Festival will be used to fund the power washing, re-rendering and re-decoration of the exterior of the Church as part of a major new programme of restoration work, in support of which the Friends has already committed a substantial grant.

If you would like an application form to join the Friends, or wish to make a donation in support of our work, please ask one of the Stewards or write to the Treasurer, Rosemary Jones, 4 Rowney Gardens, Sawbridgeworth, Herts, CM21 0AT. Alternatively you can e-mail the Chairman, Philip Hargrave, at [friends.stjames@btinternet.com](mailto:friends.stjames@btinternet.com).

## Flower Sponsors

The Friends gratefully acknowledge sponsorships:

*Remembering my Father, Arthur Frank Poole. Pauline Jacobs*  
*In memory of my loving husband, Graham. Edna Taylor*  
*Ken and Christine Tew - In memory of our parents.*  
*In memory of Lizzy - a special child. Chris Q.*  
*In memory of George Sampford and Tom & Evelyn*  
*Morton. Colin & Marjorie Sampford*  
*In memory of past friends of St James*  
*For my dear brother, John. Lina*  
*For my mother, Janet. Margaret*  
*In memory of Eva Ashwell*  
*In memory of Netta*  
*For Lily*

*and by others who wish to remain anonymous.*



## Acknowledgements

Bernard Chapman Florists for their valued help  
Hadley Nurseries at Roydon Hamlet for supplying plants  
Musicians and Flower Arrangers for the use of their talents

# Plan of Flower Arrangements

← 22 Lych Gate

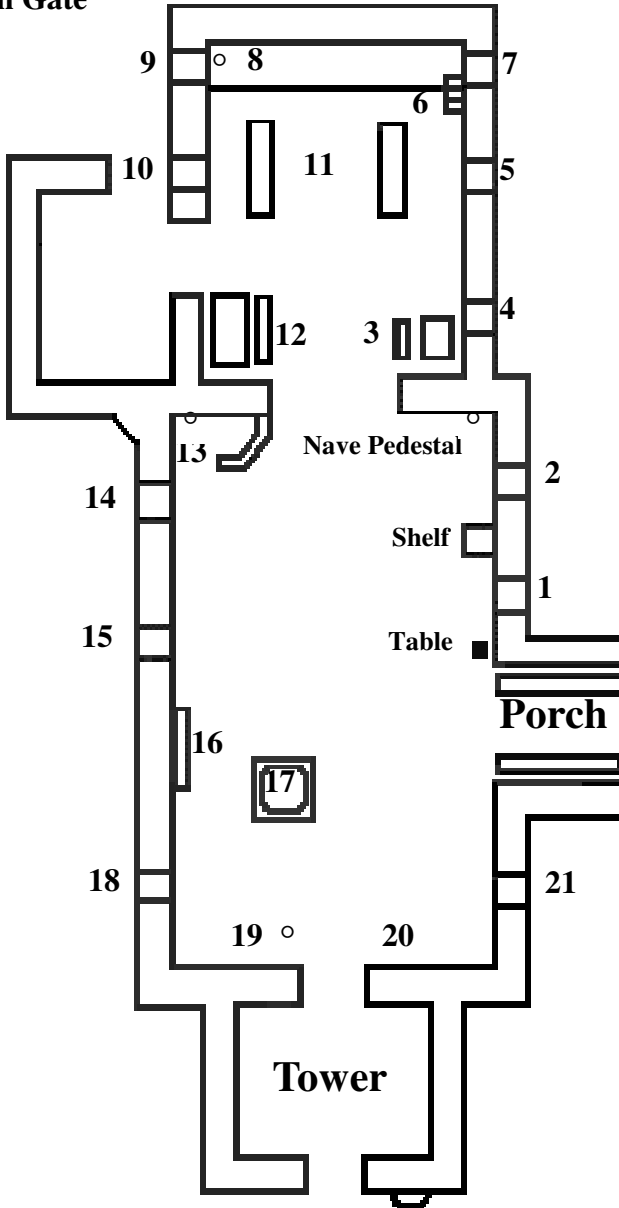

## ENCOUNTERS WITH JESUS

All who encountered Jesus were changed in some way, whether physically or spiritually. Their lives were radically altered by His loving touch and they were made to search their hearts. We too can meet with Jesus in our contemporary world and find our lives changed in His love and compassion.

### The Arrangements

|                      |  |
|----------------------|--|
| Porch                | Welcome Visitors                                 |
| Table                | The Devil  |
| Window (1)           | The Disciples                                    |
| Shelf                | Matthew – The Disciple                           |
| Window (2)           | The Haemorrhagic Woman                           |
| Nave Pedestal        | In memory of Eva Ashwell                         |
| Rector's Chair (3)   | The Blind Beggar                                 |
| Window (4)           | The Little Children                              |
| Window (5)           | The Rich Young Man                               |
| Sedilia (6)          | Zacchaeus  |
| Window (7)           | The Paralysed Man                                |
| Altar Pedestal (8)   | The Five Thousand                                |
| Window (9)           | The Roman Centurion                              |
| Window (10)          | The Temple Dealers                               |
| Choir (11)           | Jesus' Promise to Us<br>(In memory of Hope Hill) |
| Organ Bench (12)     | The Men on the Road to Emmaus                    |
| Pulpit Pedestal (13) | Lazarus  |
| Window (14)          | Martha and Mary                                  |
| Window (15)          | The Man with Leprosy                             |
| War Memorial (16)    | The Woman who Anointed Jesus                     |
| Font (17)            | The Woman at Jacob's Well                        |
| Window (18)          | Mary Magdalene                                   |
| Tower Pedestal (19)  | The Repentant Criminal                           |
| Tower Steps (20)     | The Roman Soldier                                |
| Window (21)          | Saint Paul (Saul)                                |
| Lych Gate (22)       | Prayer after Communion                           |

The Church Stewards have a list of the flower arrangers if you wish for more information about the interpretations.

## **Life @ St James the Great**

St James the Great is the Parish Church for most of Thorley and part of St Michael's Mead. We have been truly blessed with buildings, but with this blessing comes the responsibility to ensure they are maintained. Our buildings are:

- St James' Church, a Grade 1 listed building, dating from the 13th century, although thought to have been built on the site of a more ancient place of worship. This building is used for two services each Sunday morning and for informal services during the week.
- The Thorley Christian Centre, built in the 1980s, near the Thorley Park Shopping Centre.
- The Church Room, on the north side of the churchyard and rebuilt in 1994. Originally it was the first school in Thorley. On Sunday afternoons in the summer the Friends of St James use it to serve teas to those who come to tend graves or enjoy the countryside that still surrounds the Church.
- The St Barnabas Centre was opened in 1996. It was originally a 16th century tithe barn used for many years for stock rearing. It is now used for worship, church meetings and social activities by the church and also by schools and community groups in and around the Parish. It is a Grade II listed building.
- The Emmaus Centre, built on the site of an old Dutch Barn, provides modern facilities for several of the children's groups, as well as other Parish events.

However the church is far more than its buildings – it's the people and our mission 'to know Christ and to make Him known' that drive our activities and keep us coming to worship.

Last November we hosted a Cheese & Wine party to welcome the residents of Parkside to the Parish. You might have seen and heard us singing last Christmas and Easter outside Sainbury's. We also visited Parkside and Premier Court to sing carols with the residents there. During the World Cup we hired a large screen so that people could enjoy matches in the company of other football fans. Prior to this we had a meal at Chutney Joes and were interested to hear what the Revd Alan Comfort said about being a professional footballer and a Christian. During Lent Bob ran a series of evening teaching sessions based on 'Keeping Step with the Spirit'. We also ran an Alpha course for people wishing to find out more about the Christian faith. We all need to learn - and keep on learning!

From September we will be holding an evening service on the third Sunday of each month at the Thorley Christian Centre.

At 6 p.m. on Sunday, 10th September we are holding a service of prayer and thanksgiving at St James' for all who have suffered a family bereavement in the last few years.

On 7<sup>th</sup> October, Riding Lights will present 'Pipe Dreams' at the St Barnabas Centre. Visit the Outreach Stall or contact the Box Office on 01904 613000 for tickets.

The Friends of St James will be hosting a Quiz Evening on 14<sup>th</sup> October – contact Philip Hargrave on 01279 657273 for tickets.

We will be having a Parish weekend from Friday 24<sup>th</sup> to Sunday 27<sup>th</sup> November, led by the Revd Rob Richards and his wife, Anna.

Please visit the Outreach Stall where the person on duty will be delighted to tell you more about life at St James. There is also a leaflet showing what we do and how you might like to be involved.

Give us a try – we'd love to get to know you! Children are welcome at all our services.

### **St James'**

Many of our performing

Weekend. We are privileged that a number of people are willing to use their talents to worship God and to lead the music at the 9:15 and 11:15 services on Sunday mornings. This year we are pleased to be joined by members of Little Worship who will be performing some of their favourite songs. If you enjoy worshipping through music, and would like to be involved, contact our Director of Music, Simon Dellow, on 01279 771333.



### **Musicians**

musicians will be during the Festival

# Festival Programme

## Daily

|                |   |                    |
|----------------|---|--------------------|
| 12 noon - 6 pm | Flower Arrangements                           | Church             |
|                | Plant Sale                                    | St Barnabas Centre |
|                | Refreshments                                  | St Barnabas Centre |
|                | Churchyard Database                           | Church Room        |
| Various times  | <b>Musical Mystery Moments</b>                | Church             |
| As required    | Guided Tours of Church and St Barnabas Centre |                    |

## Saturday, 26th August

|                |                                     |        |
|----------------|-------------------------------------|--------|
| 2:00 - 2:30 pm | <b>Speaking to God through song</b> | Church |
| 4:00 - 4:30 pm | <b>Gospel Rock</b>                  | Church |

## Sunday, 27th August

|                 |   |                    |
|-----------------|---|--------------------|
| 12:30 - 5:00 pm | Craft Fair                              | St Barnabas Centre |
| 3:00 - 4:00 pm  | Bell Chiming                            | Church             |
| 4:30 - 5:30 pm  | <b>Hymns of praise and thanksgiving</b> | Church             |
| 6:00 - 7:00 pm  | Festival Songs of Praise                | Church             |

## Monday, 28th August

|                 |  |                    |
|-----------------|--|--------------------|
| 12 noon - 4 pm  | Mini Fete                                      | Emmaus Centre      |
| 12.30 - 5:00 pm | Craft Fair                                     | St Barnabas Centre |
| 12.00 - 1:00 pm | Bell Chiming                                   | Church             |
| 1.00 - 1:45 pm  | <b>Singing with Spirit &amp; Understanding</b> | Church             |
| 2:00 - 2:30 pm  | <b>Speaking to God through song</b>            | Church             |
| 2:45 - 3:15 pm  | <b>Little Worship</b>                          | SBC Courtyard      |
| 3:15 - 4:15 pm  | <b>Songs of everlasting praise</b>             | Church             |
| 4:30 pm         | Raffle to be drawn                             | St Barnabas Centre |
| 5:30 - 5:45 pm  | Closing Act of Worship                         | Church             |

## General Information

Wheel-chair for loan St Barnabas Centre

*There are opportunities for donations in both the Church and the St Barnabas Centre.*

Thank you for your support.