A decorative border surrounds the entire page, featuring a repeating pattern of stylized flowers and leaves. The flowers have multiple petals and a central circular element, connected by a vine-like structure with leaves.

**The Friends of
St James the Great, Chorley**
Registered Charity No: 288678
www.friends.stjames.btinternet.co.uk

**FESTIVAL
OF
FLOWERS
AND
MUSIC**

**THEME:
GREAT COMPOSERS
- CHOSEN EXCERPTS**

23RD - 25TH AUGUST 2008

PROGRAMME 50P

The Friends of St James the Great, Thorley

The Friends of St James was founded in 1983 to assist the Rector and Parochial Church Council in maintaining and beautifying the Church and Churchyard.

The Church of St James the Great dates from Norman times and is the oldest building in Thorley. It consists of a Chancel, Nave, South Porch, Vestry and embattled Western Tower. The Tower is surmounted by an oak-shingled Hertfordshire Spike and contains six bells. The Church is built of flint rubble with clunch dressings and has a total length of 100 feet.



The Chancel and Nave were built in the 13th Century in the Early English style, but the Norman Font and Doorway suggest that the Church existed at least as early as the 12th Century. The Tower was added in the 15th Century. Outside the Western Door is a Holy Water Stoop and the Church contains three remarkable 14th Century stepped sedilia, or priests' seats.

We are currently seeking to raise funds to replace our organ. Whilst still operational, its chequered history means that there are serious shortcomings in both its functionality and its ability to cope with the tonal and dynamic variation so much associated with even a relatively 'basic' organ.

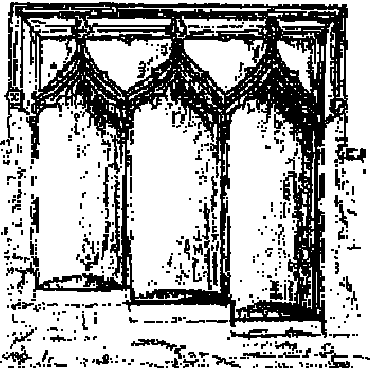

If you would like an application form to join the Friends, or wish to make a donation in support of our work, please ask one of the Stewards or write to the Treasurer, Rosemary Jones, 4 Rowney Gardens, Sawbridgeworth, Herts, CM21 0AT. Alternatively you can e-mail the Chairman, Philip Hargrave, at friends.stjames@btinternet.com.

Flower Sponsors

The Friends gratefully acknowledge sponsorships:

For Lilly.

In memory of Mollie.

In loving memory of Netta.

In memory of Duilio. Chris

In memory of Graham. Edna

For all our family. Betty Heard

In loving memory of Eileen. Reg

In memory of much loved parents.

In loving memory of Mum. Margaret

In memory of past friends and loved ones.

In memory of my parents, Betty and Doug Cage.

Christine and Ken Tew; in memory of our parents.

In memory of a beloved husband and granddaughter.

In loving memory of Mum, Dad and Skye. Bob and Brenda

In loving memory of Arthur Frank Poole. Pauline and Paul

In loving memory of George & Mary Sampford and Thomas &

Evelyn Morton. Colin & Margery.

and those by others who wish to remain anonymous.



Acknowledgements

Hadley Nurseries at Roydon Hamlet for supplying plants
Musicians and Flower Arrangers for the use of their talents

Plan of Flower Arrangements

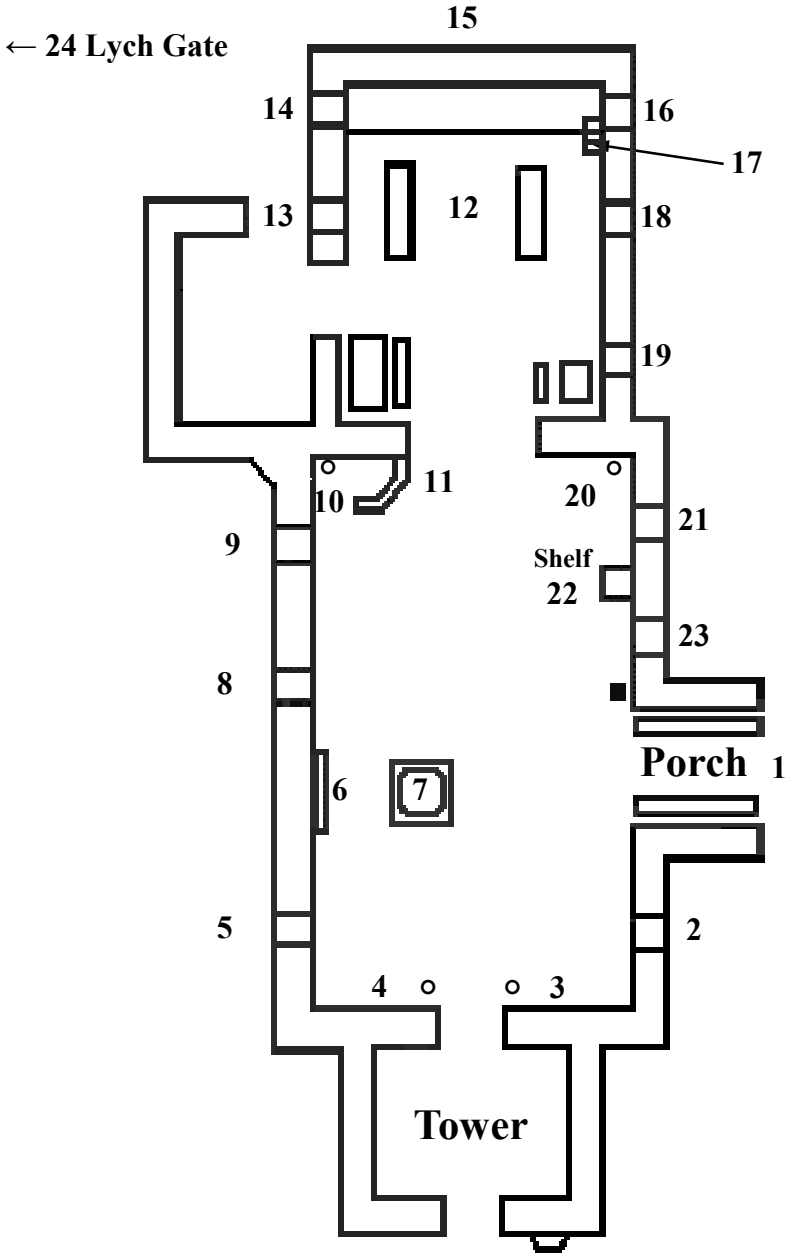

GREAT COMPOSERS—CHOSEN EXCERPTS

The Arrangements

No	Composer	Music
1	Vivaldi	The Four Seasons
2	Beethoven	The Pastoral Symphony
3	Canteloube	Songs from the Auvergne
4	J Strauss Jnr	The Blue Danube
5	Dvorjak	The New World Symphony
6	Britten	The War Requiem
7	Tchaikovsky	Swan Lake
8	Bizet	The Pearl Fishers
9 & 10	Handel	The Royal Fireworks Suite
11	Chopin	Clair de Lune
12	Rutter & Modern Composers	Eternal God
13	Mozart	The Magic Flute
14	Stravinsky	The Firebird
15	J S Bach	Sheep May Safely Graze
16	Elgar	Chanson de Matin
17	Tchaikovsky	Romeo and Juliet
18	Gershwin	An American in Paris
19	Mendelssohn	A Midsummer Night's Dream
20	Gounod	Faust
21	Puccini	Madam Butterfly
22	Handel	The Water Music
23	Verdi	The Grand March from Aida
24	Saint-Saëns	Dance Macabre

The Church Stewards hold a list of those who created the individual arrangements.

Our Living Churchyard

We are in the process of developing a Churchyard Management Plan to encourage greater diversity of wildlife.

We are undertaking this with advice from the St Albans Diocesan Environmental Officer and The Herts and Middlesex Wildlife Trust.

Our first steps in 2008 were:-

- To leave the central area uncut until August.

This was to encourage more wild flowers and grasses and also provide more diverse habitats for insects such as butterflies, moths and bats.

In 2009 this managed area will be smaller and limited to beyond the smaller yew and copper-beech trees opposite the church room.

- To mow the area immediately around the church and the Remembrance Garden on a regular basis.
- To mow / strim the more recent areas of tended graves and ashes interments on a monthly basis.
- To mow / strim the remaining areas after the Spring flowers had finished and seeded to encourage bird life.
- To maintain the hedges after the nesting season.

We are seeking advice about the health of our many ancient trees from tree specialists.

We are grateful to the parishioners who maintain the churchyard on a regular or an occasional basis.



Extra help is always most welcome. Please contact the church office if you would like to help.

Prayer for Healing



This year at the Festival we are providing an opportunity for you to receive prayer for yourself (or on behalf of someone else) for any need: physical, emotional or spiritual.

Where: The Cowshed Rooms in the St Barnabas Centre (this is a quiet private space).

When: Saturday, Sunday & Monday between 2pm & 4pm.

What do you have to do? Nothing! Just come along. You don't have to pray. Members of our trained prayer team will simply introduce themselves, ask your name and what you want prayer for. Your prayer request does not have to be for anything major, we are happy to pray with you concerning any need, large or small. Nothing that you have shared will be discussed with other people.

Why are we doing this? We do this in obedience to Jesus' command to his followers and as an expression of our love. Our aim is to follow the example of Jesus who laid hands on people to heal them and bless them.

This prayer time is not counselling and whilst the team members will pray with you and listen to God for the things that he may be saying to you, they will not give you their opinions or advice.

If after receiving prayer you feel God has touched you in anyway we would love to hear from you.

Revd Bob Payne
Rector of Thorley

Festival Programme

Daily

12 noon - 6 pm	Flower Arrangements	Church
	Plant Sale	St Barnabas Centre
	Churchyard Database and Parish Registers	Church Room
12 noon - 5:30 pm	Refreshments	St Barnabas Centre
As advertised	Solos and Duets	Church
As required	Guided Tours of Church and St Barnabas Centre	

Saturday, 23rd August

2:45-3:15 pm	Great Composers - The Eclectic Mix	Church
--------------	------------------------------------	--------

Sunday, 24th August

12 noon - 5 pm	Craft Fair	St Barnabas Centre
12 noon - 4 pm	Children's Activities	Various
12 noon - 4 pm	Mini Fete	Emmaus Centre
3:00 -4:00 pm	Bell Chiming	Church
5:00 -5:30 pm	Great Composers - The Anthem Mix	Church
6:00 -7:00 pm	Festival Songs of Praise	Church

Monday, 25th August

12 noon - 5 pm	Craft Fair	St Barnabas Centre
12 noon - 4 pm	Children's Activities	Various
12 noon - 4 pm	Mini Fete	Emmaus Centre
2:00 -3:00 pm	Bell Chiming	Church
3:45 -4:15 pm	Great Composers - The Hymn Mix	Church
4:30 pm	Raffle to be drawn	St Barnabas Centre
5:30 -5:45 pm	Closing Act of Worship	Church

General Information

Wheel-chair for loan in St Barnabas Centre

There are opportunities for donations in both the Church and the St Barnabas Centre.

Thank you for your support.